



蓄电池状态指示器 Battery Charge Indicator

■ 湖北联鸿能源科技有限公司

产品介绍:

蓄电池状态指示器又称为内装式密度计,由透明塑料管、底座和单只或两只小球组成,借助于螺纹安装在蓄电池盖上,两只颜色不同的小球安放在塑料管与底座之间的中心孔中,红色小球在上,绿色小球在下。由于两只小球是由密度不同的专材料制成的,因此可随电解液密度变化而上下浮动。

Product description:

The battery status indicator is also called a built-in density meter. It consists of a transparent plastic tube, a base and a single or two small balls. It is installed on the battery cover with the help of threads. Two small balls of different colors are placed on the plastic tube and the base. In the center hole between, the red ball is up and the green ball is down. Because the two small balls are made of special materials with different densities, they can float up and down as the electrolyte density changes.

产品特性:

当蓄电池存电充足,电解液相对密度大属于设定值时,两只小球向上浮动到极限位置,经过光线折射小球的颜色,从指示器顶部观察到的结果,中心呈红色圆点,周围呈绿色圆环,表示蓄电池技术状态良好。

Product Features:

When the battery is fully charged and the relative density of the electrolyte is high, which is the set value, the two small balls float upward to the limit position. After the light refracts the color of the small balls, the result observed from the top of the indicator is a red dot in the center. A green circle around it indicates that the battery is in good technical condition.

单球显色效果图 Single Ball Diagram

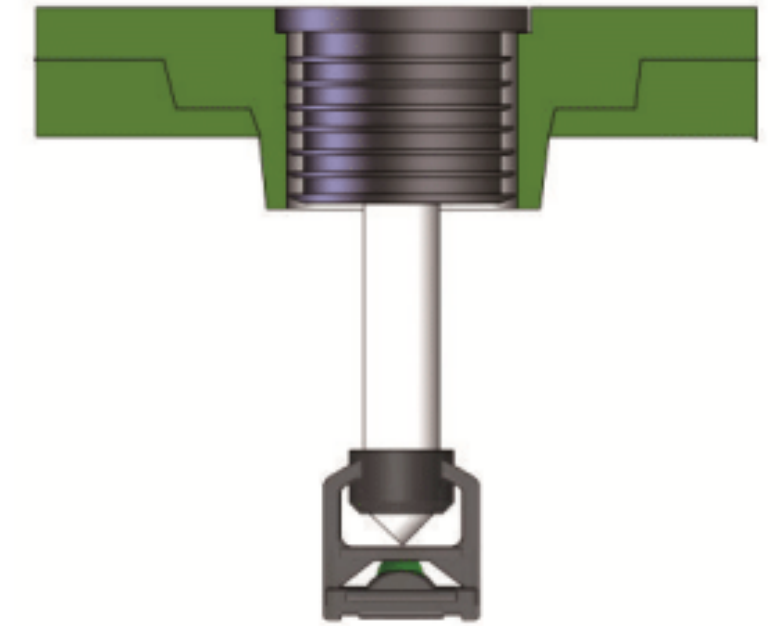
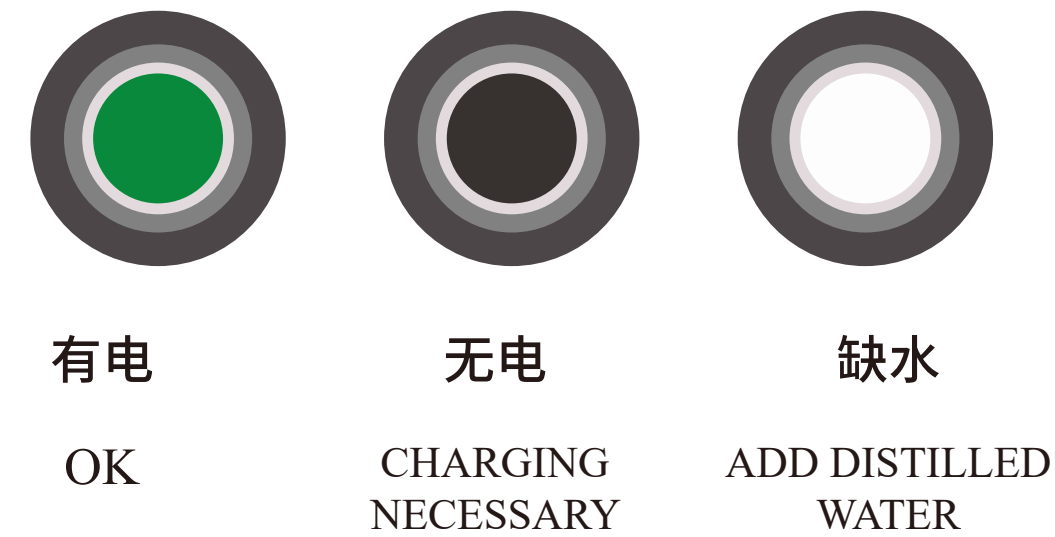

双色球显色效果图 Double Ball Diagram

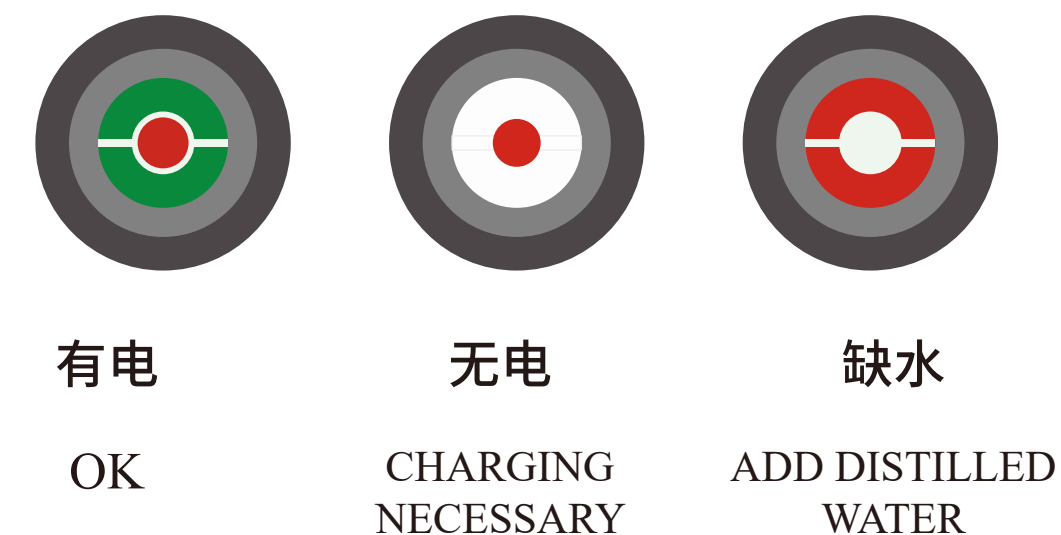

A系列 / A Serise

型号 Item NO	顶部直径 Head Diameter	长度 Lenght	产品说明 Description
A101	∅ 20	40/45/50/53/55/58/60/65/68/70/80	包塑螺旋式(双色球)双球盒/显色杆
A102	∅ 20		
A103	∅ 23		
A104	∅ 23		
A105	∅ 24		
A106	∅ 22		
A201	∅ 20	40/45/50/55/60/68	包塑螺旋式(单球盒/锥形显色杆)
A202	∅ 20		
A203	∅ 23		
A204	∅ 23		
A205	∅ 24		

C系列 / C Serise

型号 Item NO	顶部直径 Head Diameter	长度 Lenght	产品说明 Description
C101	∅ 20	38/40/45/50/53/55/58/60/65/68/70	包塑螺旋式(双色球)双球盒/显色杆
C102	∅ 20		
C103	∅ 23		
C104	∅ 23		
C105	∅ 24		
C201	∅ 20	40/42/45/48/48.7/50/52/53/55/57.7/58/60/61.9/62.5/64/65/68/70/72/75/78	包塑螺旋式(单球盒/锥形显色杆)
C202	∅ 20		
C203	∅ 23		
C204	∅ 23		

B系列 / B Serise

型号 Item NO	顶部直径 Head Diameter	长度 Lenght	产品说明 Description
B101	∅ 21.3	40/42/54/48/48.7/50/52/53/55/57.7/58/60/61.9/62.5/64/65/65.3/68/70/72/75/78	插拔式直显色杆
B102	∅ 22.9		
B104	∅ 21.3		
B105	∅ 22.9		
B401	∅ 21.3		
B402	∅ 22.9	35/40/45/50/53/55/58/60/65/68/70/80	插拔式双色球
B405	∅ 22.9		
B501	∅ 21.3	58	插拔式双色球

D系列 / D Serise

型号 Item NO	顶部直径 Head Diameter	长度 Lenght	产品说明 Description
D101	∅ 20	40/45/50/55/60/65/70	PMMA螺旋式(双色球)双球盒/一字式PMMA
D102	∅ 23	40/45/50/55/60/68	
D105	∅ 24		
D301	∅ 25	57/63	
D201	∅ 20	40/45/50/55/60/65	PMMA螺旋式(双色球)双球盒/卡扣式PMMA
D202	∅ 23	40/45/50/55/60	
D205	∅ 24		

A系列 / A Serise

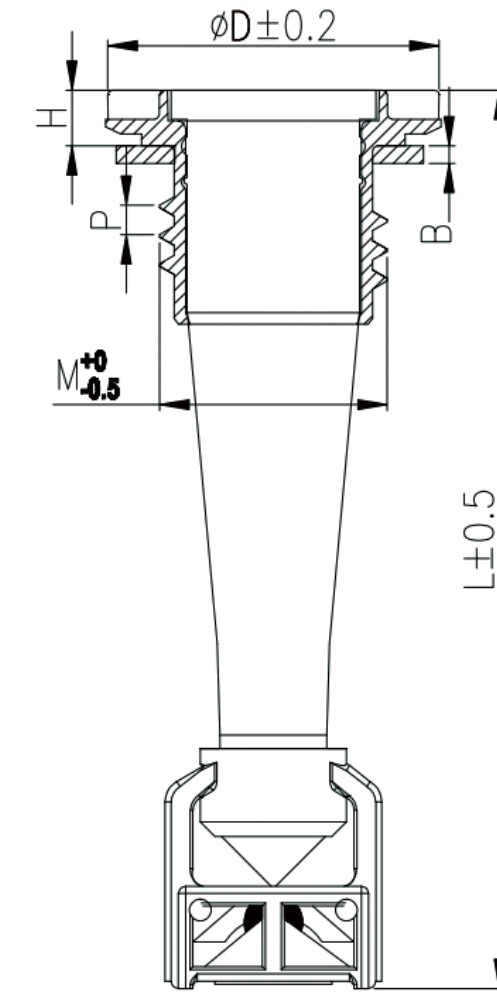
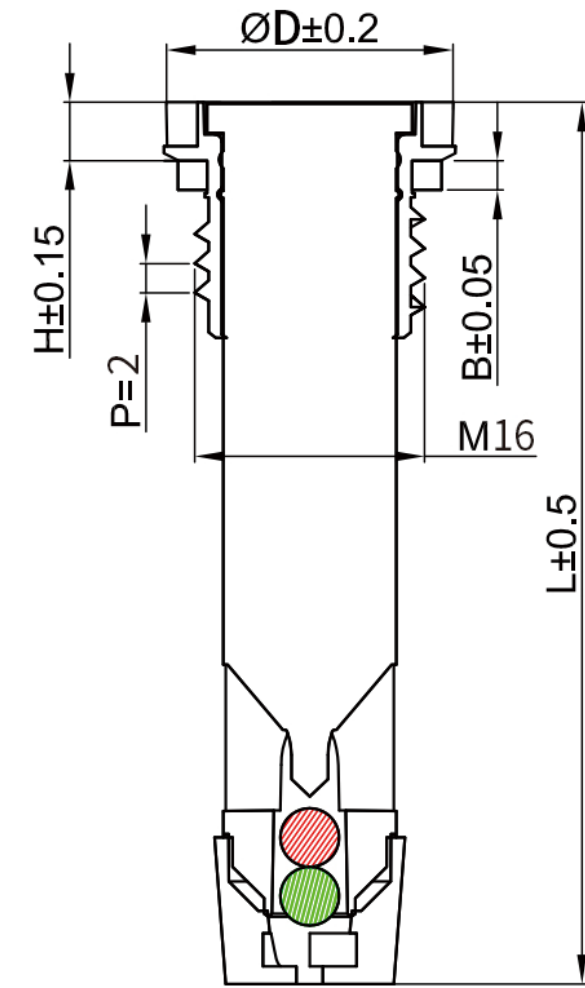

型号 Item NO	主要尺寸 (mm)						产品说明 Description
	顶部直径 Head Diameter	顶部厚度 Head Thickness	垫圈厚度 Packing Thickness	螺纹直径 Screw Diameter	螺纹间距 Screw Pitch	长度 Lenght	
	D	H	B	M	P	L	
A101	φ20	4	2.5	M16	2	35/40/45/50/ 53/55/58/60/ 65/68/70/80	包塑螺旋式(双 色球) 双色球盒 /显色杆 Plastic head with screw/2 ball/2 cage
A102	φ20	4	2.5	M15	1.5		
A103	φ23	3	1.3	M16	2		
A104	φ23	3	2.6	M15	1.5		
A105	φ24	3	1.2	M18	2.5		
A106	φ22	4	2.3	M16	2		

型号 Item NO	主要尺寸 (mm)						产品说明 Description
	顶部直径 Head Diameter	顶部厚度 Head Thickness	垫圈厚度 Packing Thickness	螺纹直径 Screw Diameter	螺纹间距 Screw Pitch	长度 Lenght	
	D	H	B	M	P	L	
A101	φ20	4	2.5	M16	2	35/40/45/50/ 53/55/58/60/ 65/68/70/80	包塑螺旋式(双 色球) 双色球盒 /显色杆 Plastic head with screw/2 ball/2 cage
A102	φ20	4	2.5	M15	1.5		
A103	φ23	3	1.3	M16	2		
A104	φ23	3	2.6	M15	1.5		
A105	φ24	3	1.2	M18	2.5		
A106	φ22	4	2.3	M16	2		

B系列 / B Serise

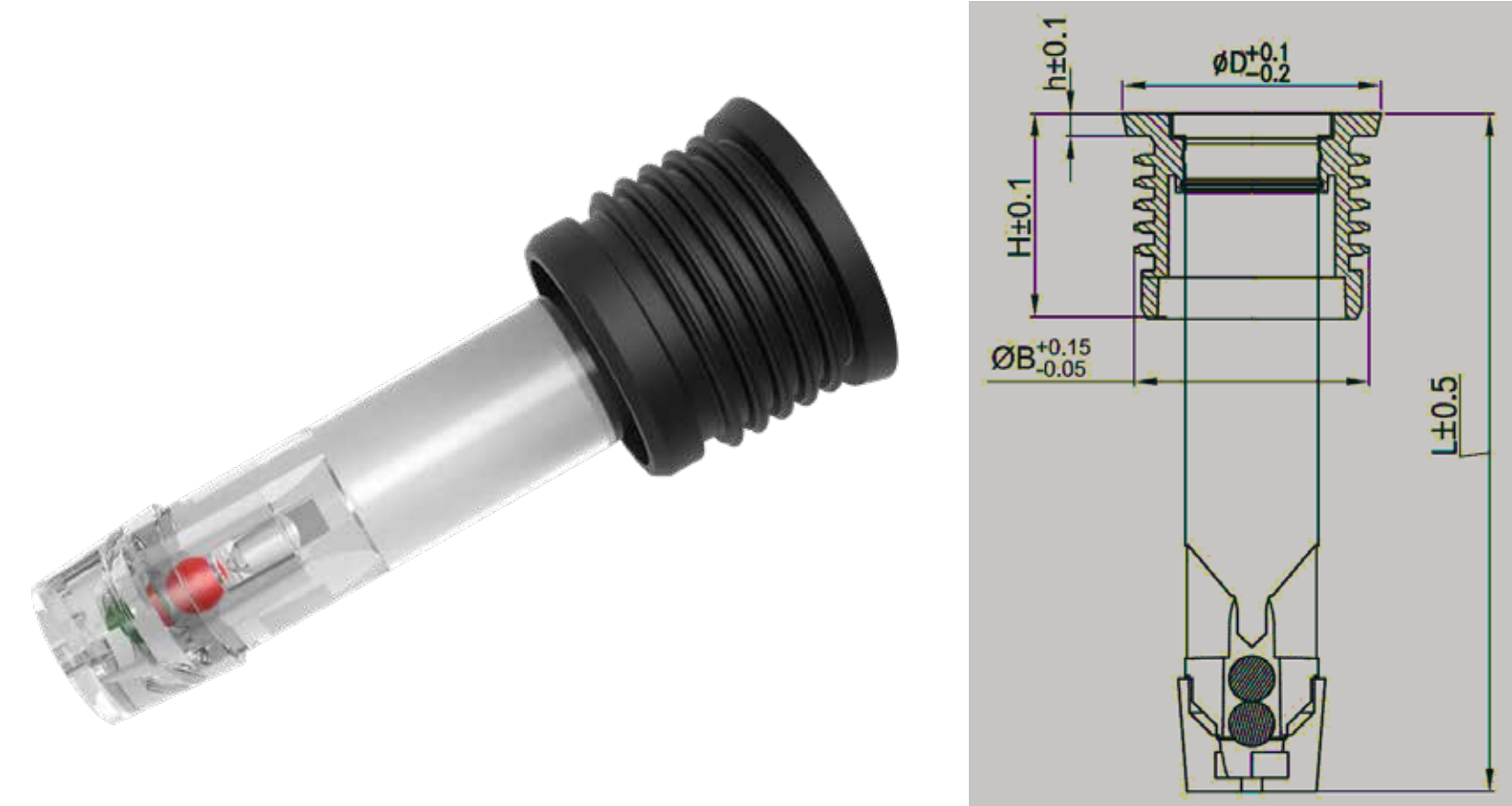

型号 Item NO	主要尺寸 (mm)					产品说明 Description
	顶部直径 Head Diameter	顶部厚度 Head Thickness	密封直径 Sealing Diameter	密封长度 Sealing Length	长度 Lenght	
	D	H	B	H	L	
B101	φ21.3	2	φ19.16	14.5	40/42/54/48/48.7/50/52/53/55/57.7/58/60/61.9/62.5/64/65/65.3/68/70/72/75/78	插拔式直显色杆 Push-in type/straight pole/cone-shaped/1 ball
B102	φ22.9	2	φ20.77	14.5		
B104	φ21.3	2	φ19.16	18		
B105	φ22.9	2	φ20.77	18		

型号 Item NO	主要尺寸 (mm)					产品说明 Description
	顶部直径 Head Diameter	顶部厚度 Head Thickness	密封直径 Sealing Diameter	密封长度 Sealing Length	长度 Lenght	
	D	H	B	H	L	
B401	φ21.3	2	φ19.16	14.5	35/40/45/50/53/55/58/60/65/68/70/80	插拔式双色球 Push-in type with 2 ball
B402	φ22.9	2	φ20.77	14.5		
B404	φ22.9	2	φ20.77	18		
B505	φ21.3	2	φ19.35	15.8		

C系列 / C Serise

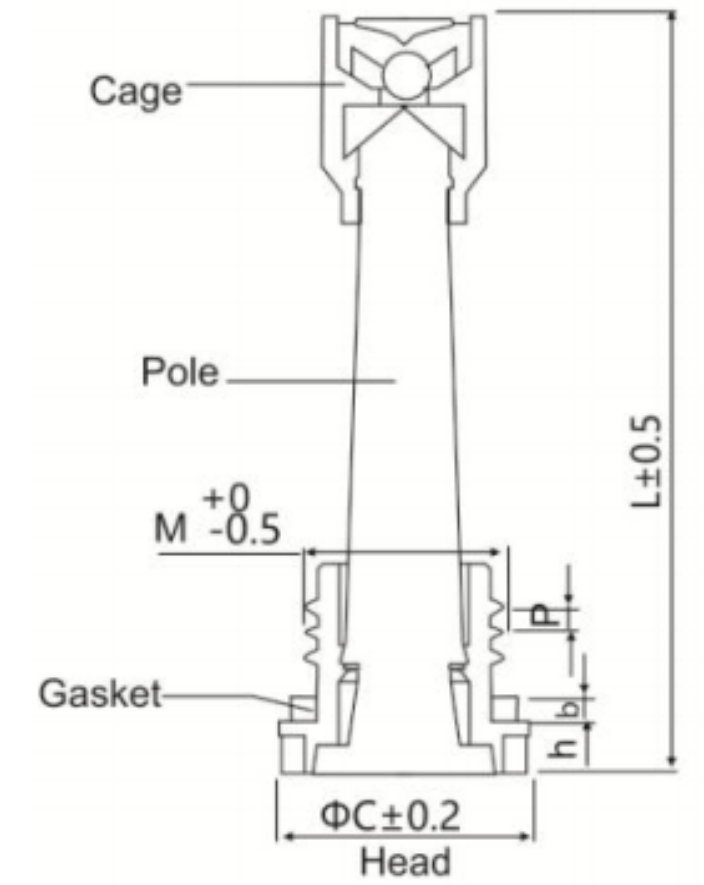
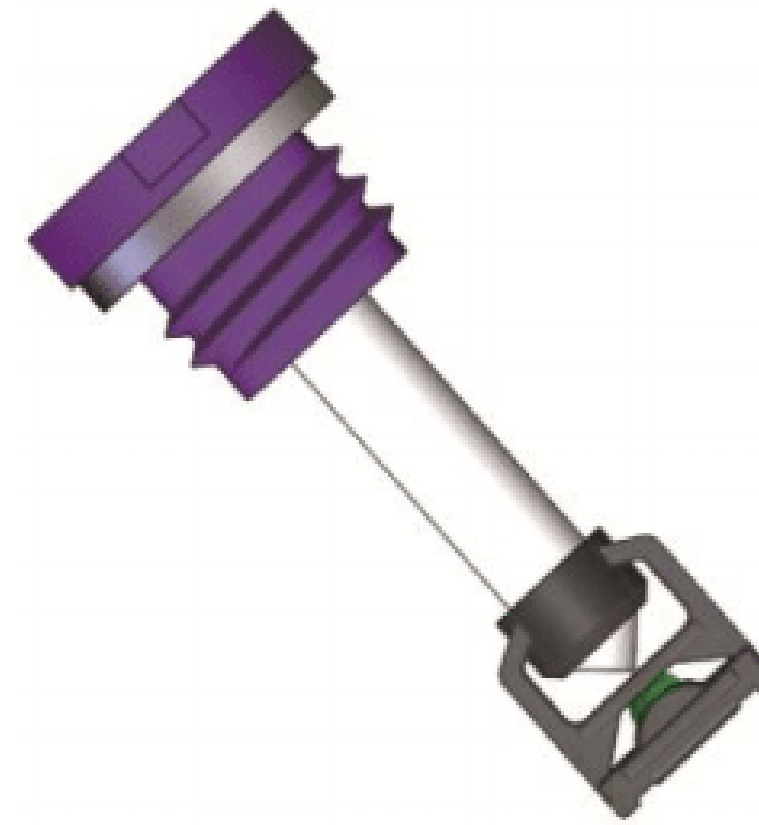
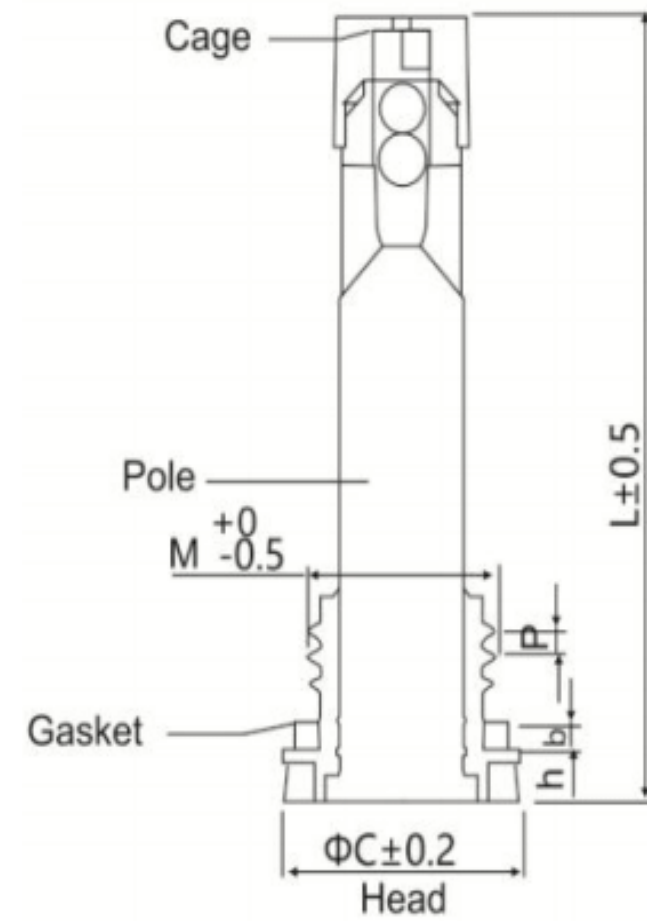
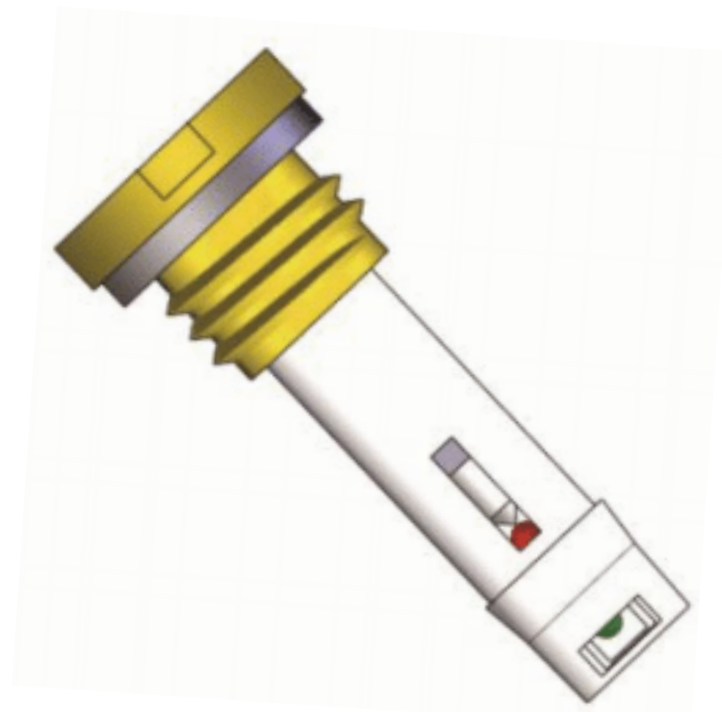

型号 Item NO	主要尺寸 (mm)						产品说明 Description
	顶部直径 Head Diameter	顶部厚度 Head Thickness	垫圈厚度 Packing Thickness	螺纹直径 Screw Diameter	螺纹间距 Screw Pitch	长度 Lenght	
	D	H	B	M	P	L	
C101	φ20	4	2	M16	2	35/40/45/50/ 53/55/58/60/ 65/68/70	包塑螺旋式(双 色球) 双色球盒 /显色杆 Plastic head with screw/2 ball/2 cage
C102	φ20	4	2	M15	1.5		
C103	φ23	3	2.6	M16	2		
C104	φ23	3	2.6	M15	1.5		
C105	φ24	3	1.2	M18	2.5		

型号 Item NO	主要尺寸 (mm)						产品说明 Description
	顶部直径 Head Diameter	顶部厚度 Head Thickness	垫圈厚度 Packing Thickness	螺纹直径 Screw Diameter	螺纹间距 Screw Pitch	长度 Lenght	
	D	H	B	M	P	L	
C201	φ20	4	2	M16	2	40/42/45/48/48. 7/50/52/53/55/5 7.7/58/60/61.9/6 2.5/64/65/68/70/ 72/75/78	包塑螺旋式(单色球) 单色球盒/锥形显 色杆 Plastic head with screw/cone-shap ed
C202	φ20	4	2	M15	1.5		
C203	φ23	3	2.6	M16	2		
C204	φ23	3	2.6	M15	1.5		

D系列 / D Serise

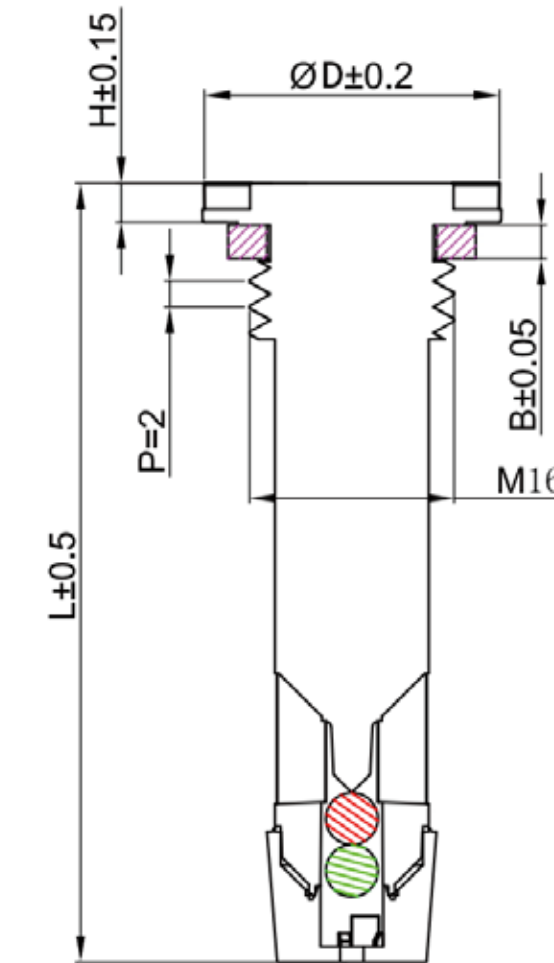
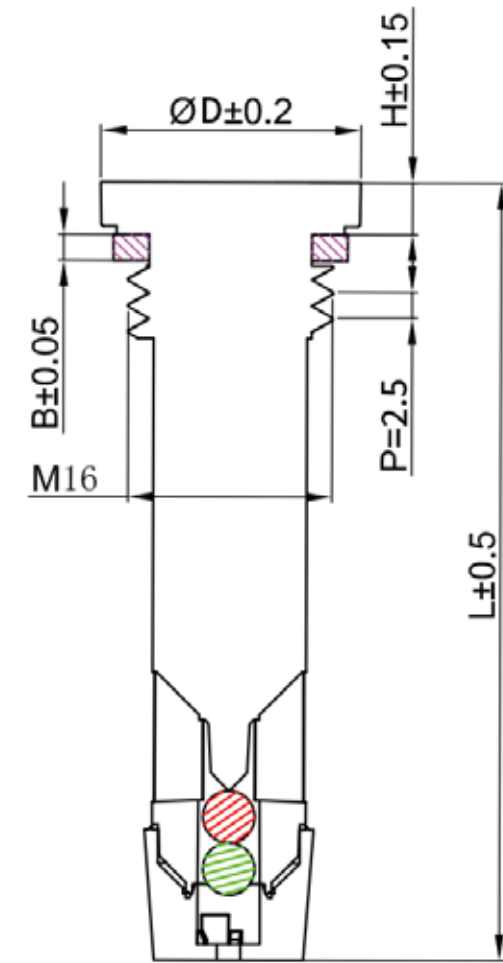

型号 Item NO	主要尺寸 (mm)						产品说明 Description
	顶部直径 Head Diameter	顶部厚度 Head Thickness	垫圈厚度 Packing Thickness	螺纹直径 Screw Diameter	螺纹间距 Screw Pitch	长度 Lenght	
	D	H	B	M	P	L	
D201	φ20	4	2	M16	2	40/45/50/55/60/65/70	PMMA螺旋式(双色球) 双色球盒/一字式PMMA Transparent head with screw/2balls/-Cointype install
D202	φ23	3	2.6	M16	2	40/45/50/55/60/68	
D203	φ24	3	1.2	M16	2.5		
D204	φ25	4	/	M18	2.5	57/63	

型号 Item NO	主要尺寸 (mm)						产品说明 Description
	顶部直径 Head Diameter	顶部厚度 Head Thickness	垫圈厚度 Packing Thickness	螺纹直径 Screw Diameter	螺纹间距 Screw Pitch	长度 Lenght	
	D	H	B	M	P	L	
D201	φ20	4	2	M16	2	40/45/50/55/60/65	包塑螺旋式(单色球) 单色球盒/锥形显色杆 Plastic head with screw/cone-shaped
D202	φ20	4	2.6	M16	2	40/45/50/55/60	
D205	φ24	3	1.2	M18	2.5		